



Digital Lucky Draw Program UI/UX Presentation

By Sales & Marketing Department

▶ Technical Details

- **Language:** 3 languages (TC/SC/EN)
- **Theme Design Customization & Reusability:** Yes
- **Customer Data Storage:** NY Server

▶ Lucky Draw Enrollment Procedures

- **Lucky Draw Invoice Eligibility Check:** Automatically scanned and validate
- **Lucky Draw Data Entry (Name, ID & Phone Number):** Manual or VIP membership integration (Autofill)
- **VIP membership app record:** yes

▶ Luckydraw Procedures

- **Methodology:** Digital/Random

▶ Development Time Frame and Budget

- **UI/UX developed by NYH digital team**
- **Leadtime:** 2-3 Months
- **Estiamted Programing Development Budget:** HKD290,000 (USD 37,000)

▶ Registration-App Integration

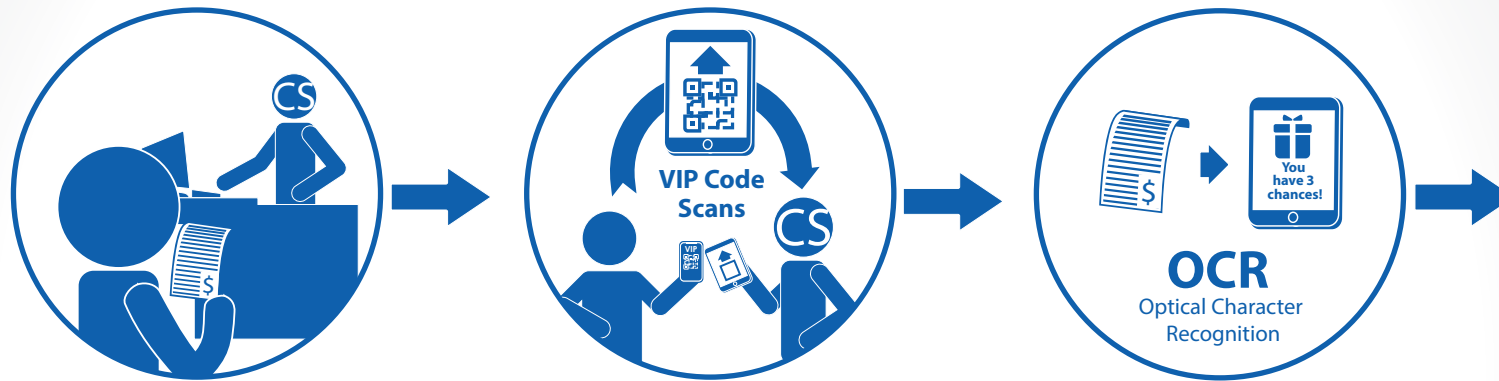

1. Queue at CS counter with receipt.

2. CS scans eVIP membership UPC/QR or enters customer info at counter

3. App based automatic eligibility validation.

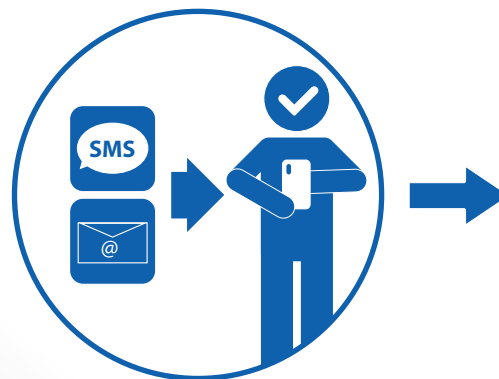

4. Confirmation through email or SMS.

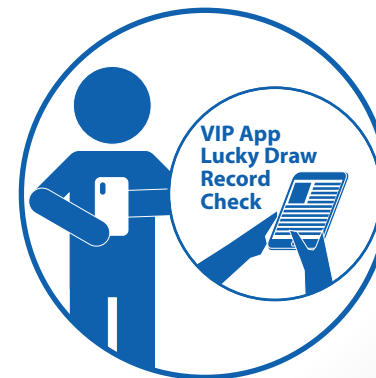

5. Lucky draw record check on our VIP membership app or website

USER LOGIN



The wireframe shows a login form within a browser window. At the top center is the New Yaohan logo. Below it is a white box titled "Login". Inside this box, there are two input fields: "Username" with an envelope icon on the right, and "Password" with a lock icon on the right. Below the fields is a blue button labeled "Login".



ENTRY SELECT

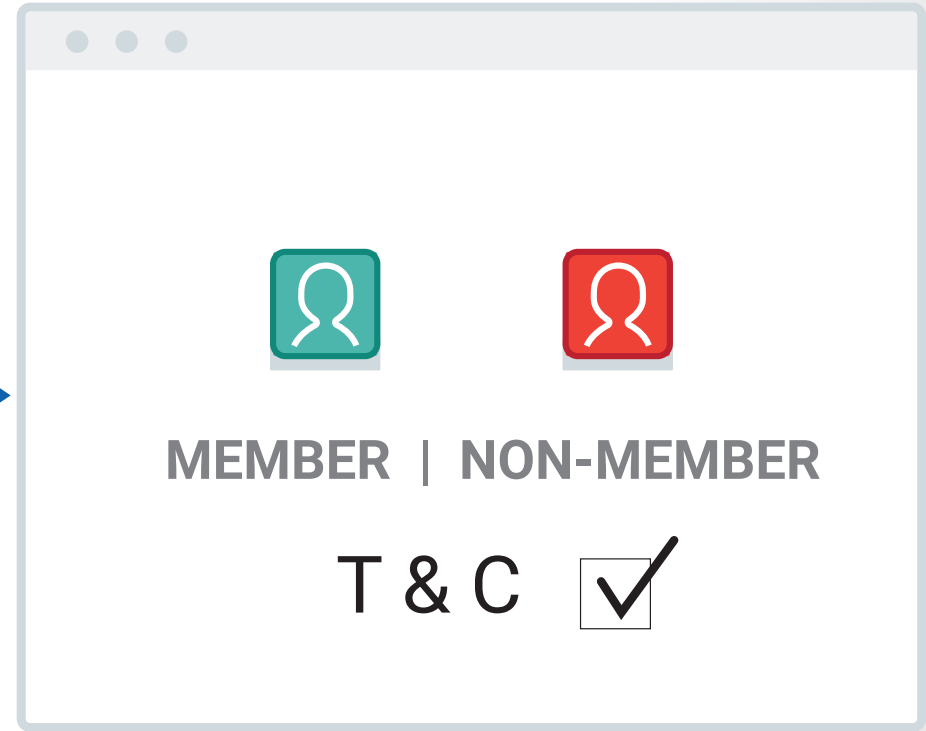

The wireframe shows an entry selection screen within a browser window. At the top center is the New Yaohan logo. Below it are two icons: a teal square with a white person icon, and a red square with a white person icon. Below the icons is the text "MEMBER | NON-MEMBER". At the bottom, there is the text "T & C" followed by a checkbox with a checkmark inside.



MEMBER

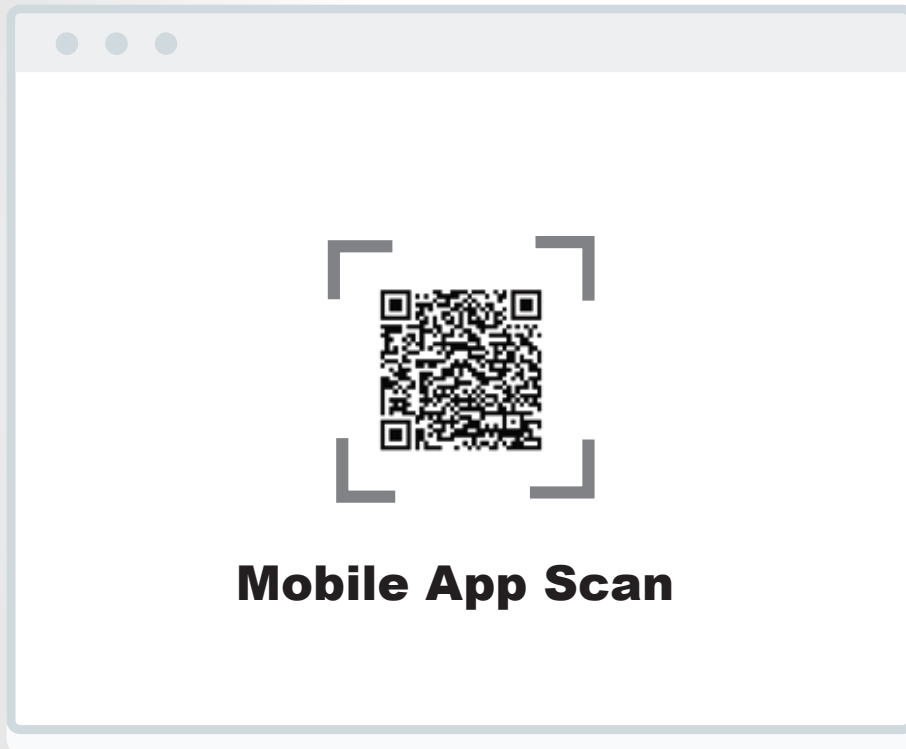

OR

NON-MEMBER

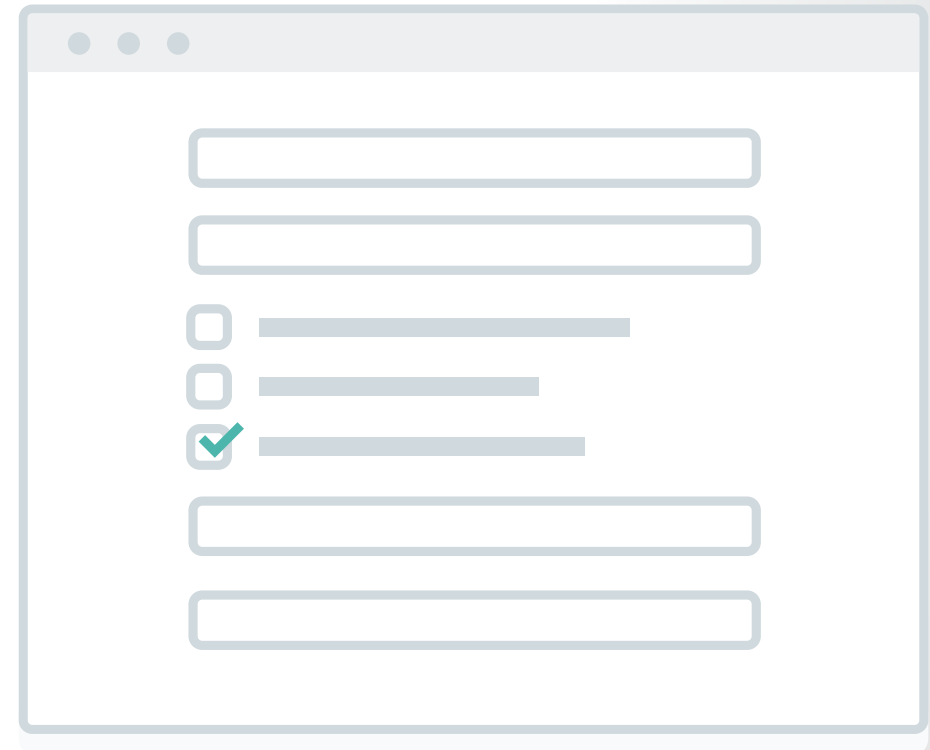

A wireframe for a non-member database re-entry search screen. It contains several input fields: two empty text boxes at the top, followed by three checkboxes with corresponding horizontal bars, and two more empty text boxes at the bottom. The third checkbox is checked with a green checkmark. The entire form is enclosed in a light gray rounded rectangle with a header bar containing three dots.



Non-member database re-entry search by:

- Full Name (ID/passport)
- ID / passport no. (first 6 digits)
- Phone number*

CONFIRM ID

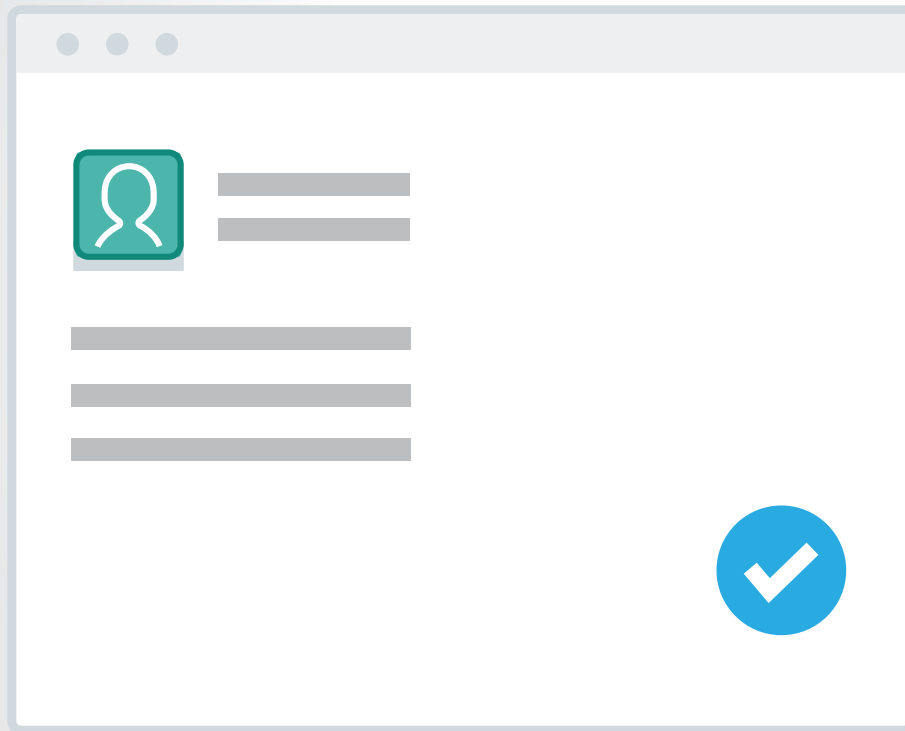

SCAN RECEIPT

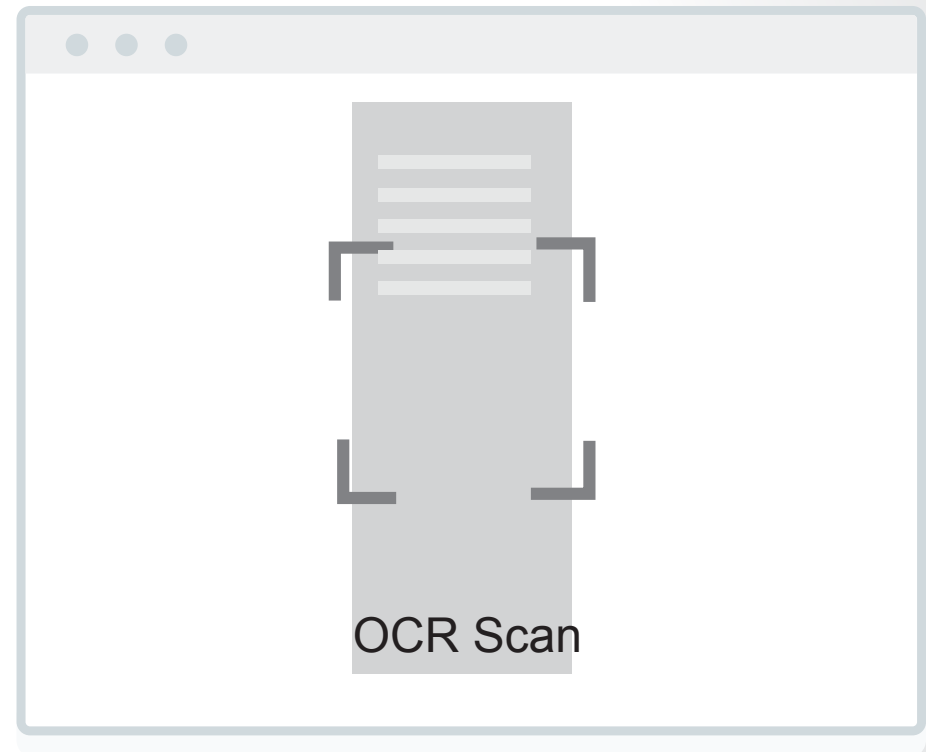

CONFIRM SCANNED INFO

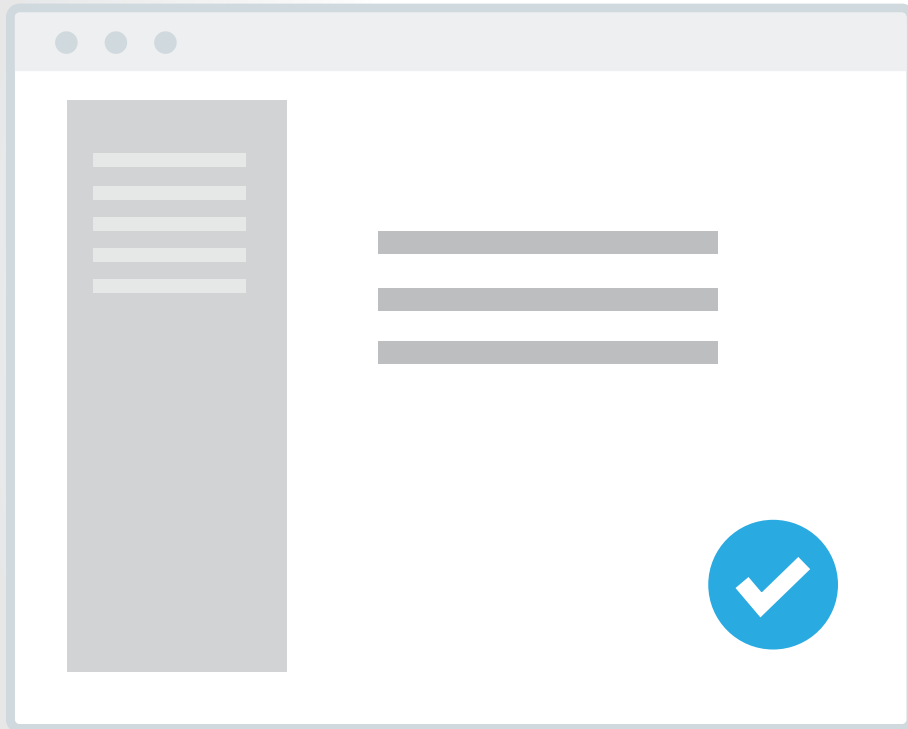

TOTAL AMOUNT / NO. OF TICKETS

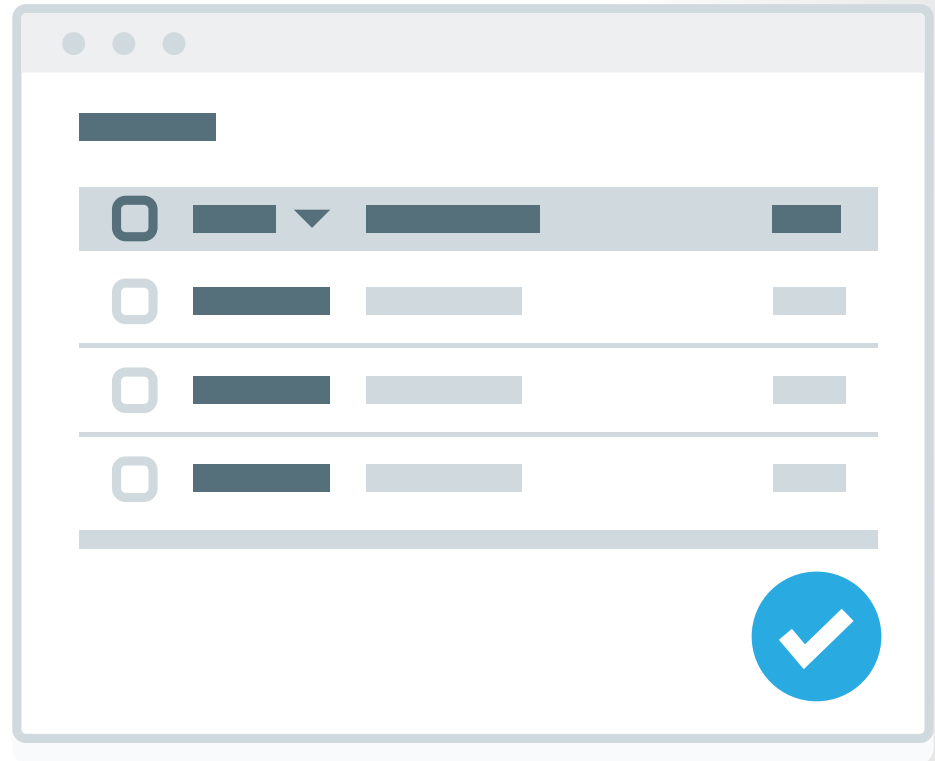

INBOX



EMAIL



PRINT OUT